

4. How will staggered arrivals, dismissals, drop off, and pick up times work?
- We are staggering the dismissal of each bus and increasing the number of entrances students may enter. This will help reduce crowding.*
 - Parents may still drop off students starting at 7:10am. First period starts at 7:36am.*
 - Staggered dismissal means that we include extra time for passing and will dismiss by floor to reduce crowding in stair wells and hallways.*
5. Can you explain the drawings on directionals of the hallways please?

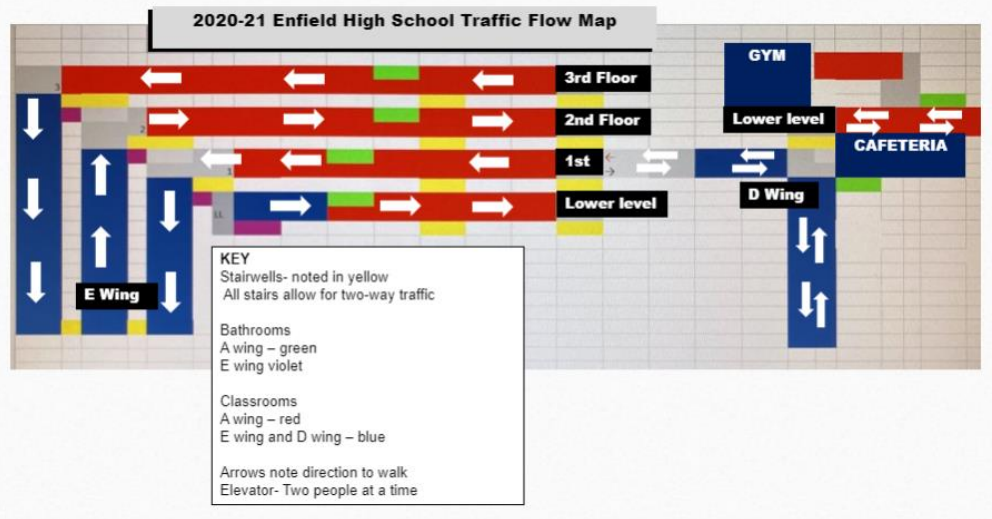

- a.
6. Will there be teaching of new concepts this year?
- Yes, teachers will do their best to follow the standard curriculum within this new framework.*
7. Are students being graded on a Pass/Fail model?
- At this time, we are not using a pass/fail model. Students will be graded using our traditional grading policy.*
8. What will the “virtual learning” part of hybrid learning look like this school year?
- It will have elements of the following: livestreaming of in-person classes, assignments students can complete on their own. We will update families as soon as a decision is made.*
9. Are masks required at all times?
- Masks are required at all times. They may be removed in designated areas during mask breaks. They may also be removed temporarily during lunch when students are eating in their classrooms or temporarily to take a sip of water.*
10. Can student wear cloth masks from home or can they only wear what's provided by the school?
- Yes, students may use their own masks as long as they cover the student’s nose and mouth.*

11. Clarification on what type of masks will be provided, how many and/or how often they'll be provided.

a. Students will be issued one cloth mask.

12. When will masks from the school be distributed to students?

a. TBD

13. Will live instruction be provided for students who have elected to do 5 days remotely and students who are at home for 2 day due to their cohort?

*a. The teacher will provide live instruction for each class on remote Wednesdays. Remote days on Mondays, Tuesdays, Thursdays, and Fridays will have elements of the following: livestreaming of in-person classes, and some assignments that students can complete on their own. We are currently working out the details for remote days, but remote students will be expected to login to Teams for at least a portion of the class to view a livestream of their teacher teaching**

*i. *The virtual learning component is still being decided at the district level. We will update families as soon as a final decision is made.*

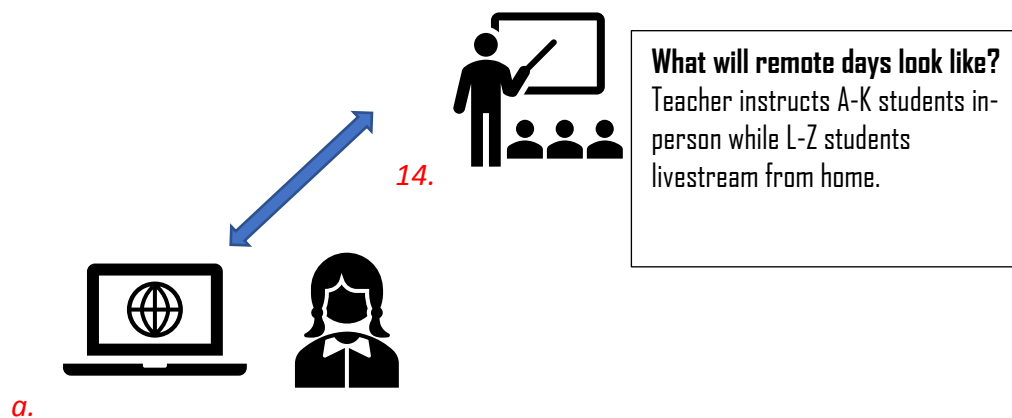

15. On remote days (WED) are synchronous live sessions always occurring or is it up to the teacher & class?

a. Synchronous sessions are a requirement for all classes on remote learning days. There is a specific schedule for remote learning days in the reopening document.

ENFIELD HIGH SCHOOL HYBRID SCHEDULE

DAY	IN-SCHOOL (SYNCHRONOUS)	REMOTE (ASYNCHRONOUS)
MONDAY	A-K last names	L-Z last names
TUESDAY	A-K last names	L-Z last names
WEDNESDAY	Remote Learning for All Students Disinfect Building	
THURSDAY	L-Z last names	A-K last names
FRIDAY	L-Z last names	A-K last names

IN SCHOOL BLOCK	START TIME	LUNCH WAVES	START TIME	WEDNESDAY REMOTE BLOCK	START TIME
1	7:36			Professional Collaboration	9:00-9:45
2	9:02			1A live Synchronous	9:45-10:30
3	10:28	1	10:28	Asynchronous	10:30-11:00
		2	11:10	2A live Synchronous	11:00-11:45
		3	11:46	LUNCH	11:45-12:15
4	12:24			3A live Synchronous	12:15-1:00
STUDENT DISMISSAL	1:42			Asynchronous	1:00-1:30
TEACHER LUNCH	1:52			4A live Synchronous	1:30-2:15
				Asynchronous / Office Hours	2:15-3:30
** Club Meetings, Mentoring Block, Office Hours				Eagle Block **	3:30-4:00

16.

17. Will the teachers offer a time to help students one by one if they fall behind or have questions during online classes?

- a. *For our remote learning Wednesdays, time has been allocated for this purpose. Students will be able to meet with staff during their office hours or during asynchronous time as needed.*

18. How are National Honor Society kids doing volunteer hours?
- a. NHS advisors will work with students to find creative ways to conduct volunteer hours safely. Advisors are Mrs. Mazzone and Mr. Onofrey.*
19. How are AP classes being taught?
- a. AP classes are covering the same curriculum in a semester that is typically taught over the course of a year. Because there is class every day for the semester, the instructional time will be comparable to our old schedule. Our students and instructors will need to adjust in reviewing for the exam. There are other schools in our area that have used a semester schedule with AP classes successfully.*
20. If the students take an AP class in the first two semesters, will they have to take the AP test at the end of the year or when they finish the class?
- a. Everyone takes the AP exam in May, regardless of when you took the class.*
21. For the AP course schedule, it seems there are a lot less days to cover everything if class is during B day?
- a. There are a fewer days for AP classes that occur in the second semester.*
22. Is there a plan to ensure that students who are in AP classes that have the class during the first semester will be prepared for the AP exams in the spring?
- a. We will work with our department coordinators and teachers to develop a plan for semesterized AP courses with a focus on instructional strategies and strategies for exam review.*
23. How will the hybrid plan effect seniors that were supposed to be dismissed at 11:30?
- a. Seniors who scheduled for early dismissal will still be dismissed when they are finished with their last class. Students will be able to leave at the conclusion of period 3.*
24. How is lunch time handled? Is the cafeteria open. do the kids need to bring their own lunch? Do they eat at their desks or in the cafeteria?
- a. Students will eat lunch at their assigned desks in the classroom. They will either bring their own lunch or they still may order school lunch from the cafeteria. They will be permitted to remove their masks while eating, but must put the mask back on when finished eating. Students must be 6' apart when removing masks to eat in classrooms.*
25. With lunch being in classrooms, will a 6 ft distance be feasible during non-masked lunch time?
- a. As long as we keep class sizes down using the hybrid model, this will be possible in most classes. In the event we have a larger section, we may have to find an alternate location for a portion of the class.*
26. Do certain rooms have certain times during the wave, so that all kids during wave 1 are not going at same time?
- a. Students are eating in their classrooms to reduce crowding, so students will not be eating in the cafeteria. Three lunch waves have been established during the third period.*
27. What happens for Eagle hour?

- a. *A block for virtual clubs and activities has been designed into our remote learning Wednesdays.*

28. Will gym class be required?

- a. *Yes, it will include modifications. This class will be meeting outdoors when possible. Instruction will be modified to include individualized sports/activities that can be socially distanced such as yoga, strength development, cross-training, power-walking, etc. See the reopening document for details.*

29. Will the high schoolers be switching classrooms for every class? If so, will all the students be in the halls at the same time? How will students be separated? "How are you going to prevent crowding on the hallways when changing classes?"

- a. *Social distancing is being promoted in a few ways. First, the hybrid model reduces the number of students in the building substantially. We are also adopting extended passing time and one-directional hallways where possible to promote distancing in the hallways. Finally, signage and decals have been ordered to serve as visuals to help students maintain distance. The administrative team has put together training modules to communicate expectations and will provide reminders and enforcement as needed.*

30. How will the HS assist with the college application process when the students are only in school 1/2 time? For Seniors, how can they still get appropriate guidance time to assist them with college applications or any other questions pertaining to college?"

- a. *Our school counseling office can meet with students in-person or remotely. In-person events such as planning nights and financial aid information sessions may be conducted virtually, if needed. Each year, once the scheduling is settled, the first task for counselors is to meet 1:1 with each of their seniors. This process will continue. Counselors will be emailing their students to set up these meetings which can occur in person on the days they are in the building or via TEAMS. Parents are welcome to join these meetings via phone or TEAMS. In addition, the department is planning on producing some online videos which will summarize information and steps to be taken and dates for completion when applicable. Details of our annual college fair are pending. We anticipate that our Financial Aid night will be held virtually. Scholarships typically get rolled out in December and January. The counseling office will send out information on this. Common APP and FASFA information will be discussed at the 1:1 meeting seniors will have with their counselor in the fall. Parents are welcome to join these meetings. In addition, online videos summarizing this information will be posted online.*

31. Will there be a "tech day" or the opportunity to schedule an appointment to "fix" current iPad for corrupt profiles, passwords, etc?

- a. *Our IT staff troubleshoots problems remotely, but contact your dean of students if you need to bring in your device for targeted repairs.*

32. I was curious if you're adding any special air filters to the hvac system to cut down on airborne transmission of the virus? I had heard the governor talking about schools looking into this.
- a. I am not aware of any plans to add special filters at this time, but I know that we are planning to increase ventilation rates.*
33. If I choose hybrid, but it ends up not working for our family can I switch to remote? If I'm not satisfied with the procedures and protocols if she starts back hybrid am I allowed to pull her and keep her completely remote?
- a. The district is asking students to commit to one plan through October 16th for our staffing purposes.*
34. Are desks going to be wiped down between each student using it?
- a. Spray bottles have been ordered for each classroom so that desks can be disinfected between periods.*
35. How will specials and electives be run? Pe, choir, culinary, Orchestra, Art, Gym, and Foreign Language-- will they be available? Are you changing the requirements for Graduates?
- a. Elective courses will continue to be offered. Activities in elective courses will be modified as needed. We are not changing the course offerings and graduation requirements.*
36. Are the classes the kids are enrolled in changing due to the hybrid schedule?
- a. We are not planning on changing student schedules unless staffing causes significant changes in our schedule.*
37. What are the current plans for Freshman orientation? Will freshman be provided Log on information, will there be a map as to where to go since he hasn't seen the school before,
- a. Freshman will have an opportunity to take a tour, get help with their iPad and view a virtual orientation video. We will provide information on login information with our opening packets that are sent out to all students. Additionally, a map will be made available to freshman on our website. We have designed a virtual freshman orientation for students to watch and will offer tours to interested freshman. Stay tuned!*
38. What is the status on Extracurricular activities and specials such as art and chorus?
- a. With the exception of sports which will be decided by the CIAC, all extracurricular activities must be conducted virtually.*
39. Will there be any type of security outside while students utilize the tents?
- a. Students will not be permitted outside without staff supervision.*

40. If students are allowed to return to a normal 5-day in-person school week, how will the new ""semester format"" be handled?"
- a. If we transition to another model, we will continue on with the semester format.*
41. Is there an adjustment to graduation requirements? Credits required? Exams?" Are there weighted classes? Ex: honors"
- a. There are no changes to graduation requirements or course offerings at this time. Adjustments may be made to the midterm/final exam schedule, but a decision has not been made as of yet. Yes, there are weighted classes.*
42. Will students require parking passes this year? If so, who do they contact to get one?
- a. Yes, students should see or contact Mrs. Moyer via email at hmoyer@enfieldschools.org the first few days of school.*
- b. Further communication will be coming to seniors and juniors concerning times to purchase passes*
43. Will a computer / tablet will be provided? Will distance learning students also be issued an iPad/tablet/laptop for accessing classes and homework?
- a. Yes, all students will be provided an iPad. If a student does not have internet access at home, they should email their grade-level dean.*
44. I need to switch to get my students on the same Monday/Tuesday as they have different last names. How do I do that?
- a. Please email Debbie Ferris at dferris@enfieldschools.org or contact your grade-level dean of students.*
45. Has the number of excused absences been adjusted? What will the attendance policy look like this year for families? (You are asking us to keep our children home for coughs or any other symptoms, but I know most parents are scared of the truancy letter and children losing credit for absences. What is the school doing to make sure this doesn't happen so parents feel safe keeping their children home, and reducing the spread?)
- a. We are following our traditional attendance policy which allows 20 absences for a traditional yearlong course and 10 absences for a traditional semester course with the understanding that we will be flexible if students have symptoms.*
46. Will all work be done on the iPads even when the children are live at school? Will they need to print at home?
- a. Much work will be done on the iPads in the classroom to reduce material sharing. There should not be a need to print at home. All work will be able to be submitted electronically.*
47. Are children being assigned to cohorts? How are those being arranged?"

- a. *The state document suggested "Cohorting, when feasible" at the high school and acknowledged that is very difficult to set up cohorts at the secondary level given the way high school schedules are structured. The way we are promoting less student interaction is by reducing classes from 8 to 4 at a time using the semester schedule.*
- 48. My girls have been awake all night since the pandemic and I have been struggling to get them to sleep and be up for the day. Can they do school work at that time and just pass it in before the deadline if I keep them home?
 - a. *Students will need to attend live sessions as part of the attendance requirement. We believe students will benefit from additional live instruction and peer interaction.*
- 49. Regarding dividing the school by alphabet - have you looked at actual alphabetical distribution of students in individual classes? There have been cases where 2/3 or more of a class has students that would fall on one side or the other, so there is not an equal split for the M/T and R/F in-person days. (For example only 4 or 5 students may show up for M/T instruction, and the remaining 15 or so students would show up for R/F instruction). Have you looked at this?
 - a. *This is correct. It's not possible to perfectly balance class schedules using this method (or a grade-level method) at the high school level given each class section is different. However, the alphabet model helps us reduce our population to a point where we can provide more spacing in our classes. Our building scheduler is reviewing each section to make sure class sizes are small enough to maintain appropriate spacing. While they will not be perfectly balanced, the hybrid model enables us to promote more social distancing.*
- 50. Regarding balancing A & B day course loads - have you considered that some students may end up with 3 or 4 core academic courses (including honors and AP courses) on A-day, and 3 or 4 elective courses on B day- making the balance of workload challenging (consider a student with maybe AP Stats and APUSH and Language on A day, and 3 Art electives on B day- what their ""semesters"" will look like. Have you looked at this?
 - a. *It is true that a student could have a more challenging workload one semester. The positive aspect of this change is that students will be able to focus on 4 classes at a time instead of 8, simplifying their workloads overall.*
- 51. How does the SOAR program fit into the planning?
 - a. *Students in the SOAR program qualify for the 4 day a week programming.*
- 52. What day will picture day be? Will school pictures have two sessions?
 - a. *School pictures are currently scheduled September 4th.*
- 53. Why are the students starting at 9:45 on online days?

- a. From our surveys and focus groups, our staff found that students were more engaged with a later start time on remote days.

54. What about Senior activities and events?

- a. *Venues have been reserved for prom, class night, and class picnic, but it is too early to make a call on senior activities. Decisions will be made based on public health data.*

55. Scholarship, grant applications, Common App, FASFA app"

- a. *Contact our School counseling office for information on applications and scholarships. Our counseling office also will hold informational sessions.*

56. "Who provides the cleaner the students use to clean their workspace as they enter and exit the room?

- a. *Teachers will handle the spray bottle and disinfectant and will be trained on how to properly use any chemicals.*

57. How will children be released to parents in pick up at end of day? (We can't line up according to floors, how will that work so students aren't standing and congregating waiting for their parent's car in line.)

- a. *We will use floor decals and verbal reminders to help students remain socially distant in areas such as these.*
- b. *Parents picking up their student should not arrive until 1:55pm, which will give the buses an opportunity to exit the campus. This will allow parents to use both Loop #1 and Loop #2 to pick their student up.*

58. Will there be any live sessions to help students and teachers learn and know their way around one note and teams?

- a. *Yes, teachers will work to provide instruction for students on how to use Teams and OneNote. Teachers are being provided PD on both OneNote and Teams this Fall and students will also have access to video tutorials as aides.*

59. Will students be told in advance how their classes will be taught?

Synchronous/Asynchronous? Will this remain consistent during this hybrid time?

- a. *There will be much more consistency regarding live instruction during both in-person and remote. Teachers will send weekly emails to communicate expectations.*

60.

61. How will parents have access to the distance learning schedule for the week for their child's class?

- a. *Parents may access student information in PowerSchool.*

62. Can you explain Eagle block and clubs to us, a little more? "

- a. *Students and staff may still meet virtually via Microsoft Teams for clubs and activities.*
63. Will there be plastic partitions around the desks? How many desks in a room?
- a. *There will not be plastic partitions around desks. We are striving to meet 6' between desks in the hybrid model.*
64. How many masks breaks will be permitted daily?
- a. *Up to discretion of teacher as breaks will need to be supervised. We will accommodate students needing additional mask breaks for medical reasons as needed.*
65. Which classes will meet outside?
- a. *We currently are only scheduling PE classes outside.*
66. Will students be trained/taught how to navigate their weekly schedule? (both in person and remote)
- a. *Yes.*
67. "How will the first day of school be implemented for students who are scheduled to be in person Thursday and Friday?
- a. *We will begin the hybrid model on day 1. Students working from home will live-stream with their classes.*
68. Will a copy of the students' full schedule be emailed to parent along with log in passwords so that parents can monitor/support them through this hybrid model of learning?"
- a. *Parents will receive information on how to login to PowerSchool to access student information.*
69. Regarding the hybrid schedule, if there is a snow day while we are in this phase, will students be able to be remote that day and have their work counted?
- a. *TBD*
70. Are there guidelines for the types of masks that can be worn at school? (besides the school supplied mask)
- a. *Mask must cover nose and mouth.*
71. Will seniors who have senior privilege to leave early (no 4th period), have to sit through all 3 lunch waves before they can leave?"
- a. *Seniors can only leave period 3 early if they have the last lunch wave. Otherwise, they would be missing class time.*
72. Will students be tested for COVID at school?

a. Currently, there are no plans for testing students at school.

73. What is the reliability of the school's internet network? Are there other better/alternative technology options, laptops, other tablets?

a. We meet with our IT department weekly to discuss issues like bandwidth and connectivity. We have been assured that we have sufficient bandwidth. However, to further ensure this, students may be asked to turn off their personal devices.

74. How does ""extra help"" work for the children that qualify for additional services? Or if they need help in say math?

a. Time has been allocated on remote learning Wednesday for office hours and asynchronous time.

75. If a student or teacher contracts Covid, how will we be notified? What will happen if there is a covid case at the school? What is the protocol if someone shows symptoms, test positive, or has been in contact with someone that test positive, will all the students from their classes be required to quarantine?

a. See reopening document. Our school nurses will work with district administration and the public health department to determine who needs to be quarantined and who needs to be notified in the event of a positive case.

76. What are SATs looking like? Will the in-school SAT day take place, since it is scheduled on a Wednesday?

a. Communication will be sent to the Class of 2021 with updated information.

77. How is social distancing going to be carried out on the buses? How many children will be on his bus? How will the seating on the bus be? Assigned?

- a. Smyth Bus is expecting half the capacity with the hybrid model which will reduce the number of students.*
- b. Monday & Tuesday A-K Riders must wear masks at all times;*
- c. AM Run - Gr. 6-12 Riders will load from the back of the bus to the front and should not touch any seat while getting to their seats – Students in grades K-5 will be assigned seats;*
- d. Siblings can sit together;*
- e. Students cannot change seats once they have been seated;*
- f. Arrive at the school AM - Riders will disembark from the front of the bus to the back and should not touch any seats while getting off of the bus;*
- g. Bus Drivers will disinfect the bus before the afternoon pickup;*
- h. PM Run – repeat the same steps above;*
- i. Wednesdays, buses will be all thoroughly disinfected;*
- j. Thursday & Friday AM/PM L-Z Riders (repeat steps above).*

78. My child attends Greater Hartford Academy of Arts 1/2 days. Will there be a bus going to the Magnet school Still and will her schedule allow her to go?"

a. GHAA parents have been contacted. If you did not receive a call, please contact Connell Clark

79. How do I access and complete the Powerschool Annual update so my daughter will be allowed to borrow an ipad?

a. The district is excited to release a "Returning Student Registration" packet that will be completed through your parent PowerSchool account. Specific directions and the link should be available SOON.

b. This will significantly reduce the number of forms your student will bring home on day 1. This registration must be completed by all families each school year. This online packet will allow you to update information and sign off on school agreements such as the iPad Agreement.

80. What is the approximate number of students per class?

a. With the hybrid model, class sizes will vary by section but will average at about 10-11 students per class.

81. "Some clarification on how orchestra will work this year. More about the instruction/class piece as opposed to concerts. What would band look like? Will they be provided with specialty masks for woodwinds or will they need to purchase them as part of a school supply?"

a. With the most recent addendum sent out from the state on 8/14 regarding requirements for music programs, we are working to find solutions but do not have updates at this point. As soon as we have concrete information to share, we will let students and families know. We wish we had more concrete answers but are having to adapt to the information just received from the state.

82. I would like confirmation that children who choose a remote learning can still participate in sports.

a. Yes, they may.

83. If students are having a virtual day will they still be able to participate in sports practice?

a. Yes

84. What is the status on sports and spectators?

a. Our athletic director is working with the CIAC and our district office to make decisions on fall sports. We are still continuing to discuss all aspects of our athletic activities including spectators at events.

85. How will busing work for sports (in particular hockey)?

a. Athletic transportation will be based off of the State guidelines including wearing of masks, loading back to front, and a pre-determined bus density based on the

determined safety level of safe, low or moderate. Future consideration may be the encouragement of parents to provide transportation to events to decrease amount of athletes needed for transportation.

86. Will students that are participating in fall sports need a ride to school to attend practice on the 3 days that they are learning remotely?

a. Yes.

87. How and when can we drop off physicals??

a. Physicals can be emailed to our nurses at alord@enfieldschools.org or jspera@enfieldschools.org. Nurses will also be available prior to first practices to drop off physicals and get confirmation from the nurses.